



Victoria Mill, Houldsworth Street, Reddish
Offers In The Region Of £110,000

Ascend
Built on higher standards

Victoria Mill, Houldsworth Street, Reddish

CASH BUYERS ONLY - Tenant is on a fixed term contract until August 2025

Nestled in the heart of Reddish, Victoria Mill on Houldsworth Street offers a unique opportunity to own a piece of history in this striking mill conversion. This spacious one-bedroom apartment, boasting characterful features, is a true gem in a popular residential location.

As you step into this charming property, you are greeted by an open plan living room seamlessly integrated with a fitted kitchen, perfect for entertaining guests or simply relaxing in style. This delightful apartment provides ample space for comfortable living.

One of the standout features of this property is the secure allocated parking, a coveted convenience in this bustling area. Built in 2007, this apartment combines modern amenities with the historic charm of the mill conversion, offering a truly unique living experience.

Conveniently located within easy reach of amenities and transport links, this apartment is ideal for those seeking a blend of urban convenience and historical allure. Don't miss out on the opportunity to make this apartment your own and experience the best of Reddish living.

*Marketing images have been used for advertising purposes. Fixtures and fittings may vary.



Please note that we have not tested any apparatus, equipment, fixtures, fittings or services, and so cannot verify they are in working order or fit for their purpose. Furthermore solicitors should confirm moveable items described in the sales particulars are, in fact, included in the sale since circumstances do change during marketing or negotiations. A final inspection prior to exchange of contracts is also recommended. Although we try to ensure accuracy, measurements used in this brochure may be approximate. Therefore if intending purchasers need accurate measurements to order carpeting or to ensure existing furniture will fit, they should take such measurements themselves.

GROUND FLOOR 458 sq.ft. (42.5 sq.m.) approx.

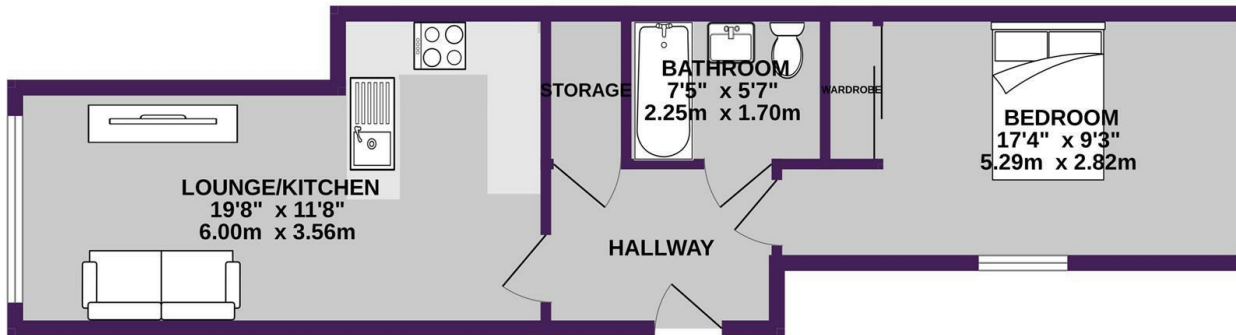

TOTAL FLOOR AREA : 458 sq.ft. (42.5 sq.m.) approx.
Whilst every attempt has been made to ensure the accuracy of the floorplan contained here, measurements of doors, windows, rooms and any other items are approximate and no responsibility is taken for any error, omission or mis-statement. This plan is for illustrative purposes only and should be used as such by any prospective purchaser. The services, systems and appliances shown have not been tested and no guarantee as to their operability or efficiency can be given.
Made with Metropix ©2024

